

SECTION B | **Hydraulic Fittings**

Series HW Crimp Fittings

Series KW Crimp Fittings

Series PW Crimp Fittings

Series RW Crimp Fittings

Series R5 Reusable Fittings

Series SB Crimp Fittings

Series SH Crimp Fittings

Series SW Crimp Fittings

Series TC/TS Crimp Fittings

Unisource “SW” series fittings are cost effective, permanent, style crimp fittings made for easy and quick assembly using our family of Unisource crimpers. Compatible with thermoplastic hydraulic hose.

SERIES SW CRIMP FITTINGS

(FOR THERMOPLASTIC HOSE SERIES 4700, 4700T, 4704NC, 4704NC-T, 4730LT, 4800, 4800NC)

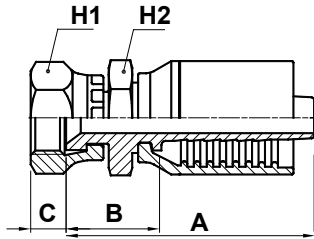

STYLE FJ-SW

JIC Female Swivel
37° Flare

Part No.	Thread Size	Hose ID (Inches)	Dimensions									
			A		B		C		H1		H2	
			in	mm	in	mm	in	mm	in	mm	in	mm
4FJ-3SW	7/16-20	3/16	1.44	36.6	.720	18.3	.340	8.7	.560	14.2	.560	14.2
4FJ-4SW	7/16-20	1/4	1.71	43.4	.720	18.3	.340	8.7	.560	14.2	.560	14.2
5FJ-4SW	1/2-20	1/4	1.75	44.5	.760	19.3	.370	9.5	.625	15.8	.560	14.2
6FJ-4SW	9/16-18	1/4	1.77	45.0	.820	20.8	.370	9.5	.690	17.5	.560	14.2
5FJ-5SW	1/2-20	5/16	1.84	46.7	.820	20.8	.370	9.5	.625	15.8	.625	15.8
6FJ-5SW	9/16-18	5/16	1.86	47.2	.820	20.8	.370	9.5	.690	17.5	.625	15.8
6FJ-6SW	9/16-18	3/8	1.85	47.0	.880	22.4	.370	9.5	.690	17.5	.690	17.5
8FJ-6SW	3/4-16	3/8	1.90	48.3	.915	23.2	.460	11.7	.874	22.2	.690	17.5
8FJ-8SW	3/4-16	1/2	2.08	52.8	.978	24.8	.460	11.7	.874	22.2	.813	20.7
10FJ-8SW	7/8-14	1/2	2.10	53.3	1.00	25.4	.500	12.7	1.00	25.4	.874	22.0

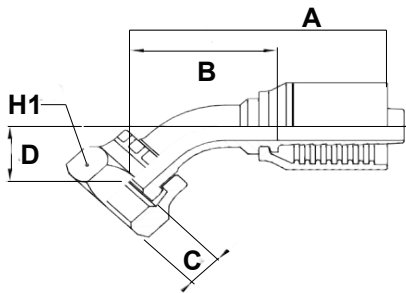

STYLE FJ45T-SW

JIC Swivel Female
37° Flare
45° Bent Tube

Part No.	Thread Size	Hose ID (Inches)	Dimensions									
			A		B		C		D		H1	
			in	mm	in	mm	in	mm	in	mm	in	mm
4FJ45T-3SW	7/16-20	3/16	1.93	49.0	1.25	31.8	.340	8.7	.390	9.9	.560	14.2
4FJ45T-4SW	7/16-20	1/4	2.19	55.6	1.25	31.8	.340	8.7	.390	9.9	.560	14.2
6FJ45T-5SW	9/16-18	5/16	2.53	64.3	1.50	38.1	.370	9.5	.430	10.9	.690	17.5
6FJ45T-6SW	9/16-18	3/8	2.57	65.3	1.56	39.7	.370	9.5	.430	10.9	.690	17.5
8FJ45T-6SW	3/4-16	3/8	2.76	70.1	1.75	44.5	.460	11.7	.590	15.0	.874	22.2
8FJ45T-8SW	3/4-16	1/2	2.72	69.1	1.63	41.4	.460	11.7	.590	15.0	.874	22.2
10FJ45T-8SW	7/8-14	1/2	2.76	70.1	1.63	41.4	.500	12.7	.630	16.0	1.00	25.4

Hydraulic Hose

A

Hydraulic Fittings

B

Support Products & Crimping Equipment

C

Technical Information & Guidelines

D

SERIES SW CRIMP FITTINGS

(FOR THERMOPLASTIC HOSE SERIES 4700, 4700T, 4704NC, 4704NC-T, 4730LT, 4800, 4800NC)

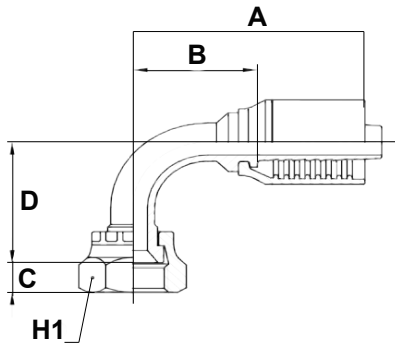

STYLE FJ90T-SW

JIC Swivel Female
37° Flare
90° Bent Tube

Part No.	Thread Size	Hose ID (Inches)	Dimensions									
			A		B		C		D		H1	
			in	mm	in	mm	in	mm	in	mm	in	mm
4FJ90T-3SW	7/16-20	3/16	1.75	44.0	1.06	27.0	.34	8.7	.830	21.0	.560	14.2
4FJ90T-4SW	7/16-20	1/4	2.01	51.0	1.06	27.0	.34	8.7	.830	21.0	.560	14.2
6FJ90T-4SW	9/16-18	1/4	2.01	51.0	1.06	27.0	.37	9.5	.910	23.1	.690	17.4
6FJ90T-5SW	9/16-18	5/16	2.14	54.0	1.13	28.0	.37	9.5	.910	23.1	.690	17.5
6FJ90T-6SW	9/16-18	3/8	2.22	56.0	1.25	32.0	.37	9.5	.910	23.1	.690	17.5
8FJ90T-6SW	3/4-16	3/8	2.55	64.8	1.56	39.6	.46	11.7	1.15	29.1	.874	22.2
8FJ90T-8SW	3/4-16	1/2	2.48	63.0	1.38	35.0	.46	11.7	1.15	29.1	.874	22.2
10FJ90T-8SW	7/8-14	1/2	2.48	63.0	1.38	35.0	.50	12.7	1.26	32.0	1.00	25.4

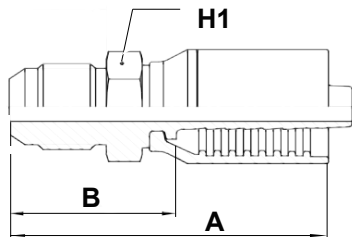

STYLE MJ-SW

JIC Male Rigid
37° Flare

Part No.	Thread Size	Hose ID (Inches)	Dimensions					
			A		B		H1	
			in	mm	in	mm	in	mm
4MJ-3SW	7/16-20	3/16	1.83	46.0	1.13	28.0	.560	14.2
4MJ-4SW	7/16-20	1/4	2.10	53.0	1.13	28.0	.560	14.2
5MJ-4SW	1/2-20	1/4	2.10	53.0	1.13	28.0	.560	14.2
6MJ-4SW	9/16-18	1/4	2.14	54.0	1.19	30.0	.688	17.5
6MJ-5SW	9/16-18	5/16	2.22	56.0	1.19	30.0	.688	17.5
6MJ-6SW	9/16-18	3/8	2.15	55.0	1.19	30.0	.625	17.5
8MJ-6SW	3/4-16	3/8	2.25	57.0	1.25	31.8	.812	20.6
8MJ-8SW	3/4-16	1/2	2.40	61.0	1.31	33.0	.874	22.2
10MJ-8SW	7/8-14	1/2	2.60	66.0	1.50	38.0	.938	23.8

SERIES SW CRIMP FITTINGS

(FOR THERMOPLASTIC HOSE SERIES 4700, 4700T, 4704NC, 4704NC-T, 4730LT, 4800, 4800NC)

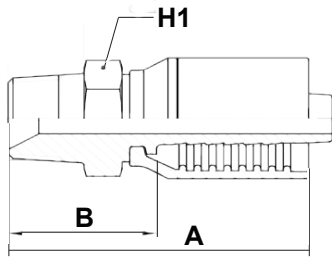

STYLE MP-SW

NPTF Male Rigid

Part No.	Thread Size	Hose ID (Inches)	Dimensions					
			A		B		H1	
			in	mm	in	mm	in	mm
4MP-4SW	1/4-18	1/4	2.09	53.0	1.13	28.0	.560	14.2
6MP-4SW	3/8-18	1/4	2.16	55.0	1.19	30.0	.690	17.5
4MP-5SW	1/4-18	5/16	2.11	54.0	1.12	28.0	.560	14.2
4MP-6SW	1/4-18	3/8	2.16	55.0	1.19	30.0	.690	17.5
6MP-6SW	3/8-18	3/8	2.16	55.0	1.19	30.0	.750	19.1
8MP-6SW	1/2-14	3/8	2.25	57.0	1.25	32.0	.874	22.2
8MP-8SW	1/2-14	1/2	2.55	65.0	1.48	37.0	.874	22.2

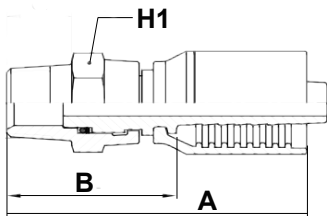

STYLE MS-SW

NPTF Male Swivel

Part No.	Thread Size	Hose ID (Inches)	Dimensions					
			A		B		H1	
			in	mm	in	mm	in	mm
4MS-4SW	1/4-18	1/4	2.24	57.0	.965	24.5	.690	17.5
6MS-6SW	3/8-18	3/8	2.56	65.0	1.09	27.7	.874	22.2
8MS-8SW	1/2-14	1/2	2.80	71.2	1.16	29.4	1.00	25.4

Hydraulic Hose

A

Hydraulic Fittings

B

Support Products & Crimping Equipment

C

Technical Information & Guidelines

D

SERIES SW CRIMP FITTINGS

(FOR THERMOPLASTIC HOSE SERIES 4700, 4700T, 4704NC, 4704NC-T, 4730LT, 4800, 4800NC)

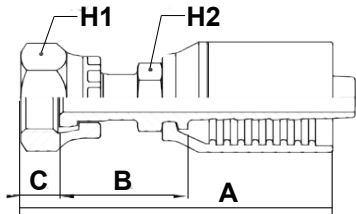

STYLE OFS-SW

O-Ring Face Seal
Female Swivel

Part No.	Thread Size	Hose ID (Inches)	Dimensions									
			A		B		C		H1		H2	
			in	mm	in	mm	in	mm	in	mm	in	mm
4OFS-4SW	9/16-18	1/4	1.84	46.7	.860	21.8	.330	8.5	.690	17.5	.560	14.2
6OFS-5SW	11/16-16	5/16	1.92	48.8	.880	22.3	.370	9.5	.810	20.6	.690	17.5
6OFS-6SW	11/16-16	3/8	1.91	48.5	.940	23.9	.370	9.5	.810	20.6	.690	17.5
8OFS-8SW	13/16-16	1/2	2.10	53.3	.960	24.4	.420	10.7	.938	23.8	.866	22.0

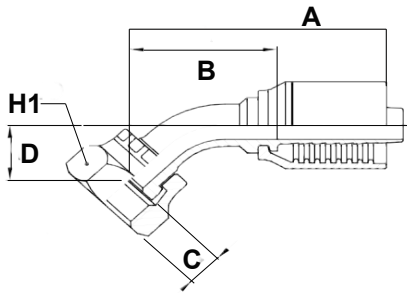

STYLE OF45T-SW

O-Ring Face Seal
Female Swivel
45° Bent Tube

Part No.	Thread Size	Hose ID (Inches)	Dimensions									
			A		B		C		D		H1	
			in	mm	in	mm	in	mm	in	mm	in	mm
4OF45T-4SW	9/16-18	1/4	2.25	51.0	1.25	32.0	.330	8.5	.390	10.0	.668	17.5
6OF45T-4SW	11/16-16	5/16	2.27	58.0	1.31	33.0	.370	9.5	.810	.430	.812	20.6
6OF45T-6SW	11/16-16	3/8	2.35	60.0	1.38	35.0	.370	9.5	.810	.430	.812	20.6
8OF45T-8SW	13/16-16	1/2	2.72	69.0	1.63	41.0	.420	10.7	.930	.590	.988	23.8

SERIES SW CRIMP FITTINGS

(FOR THERMOPLASTIC HOSE SERIES 4700, 4700T, 4704NC, 4704NC-T, 4730LT, 4800, 4800NC)

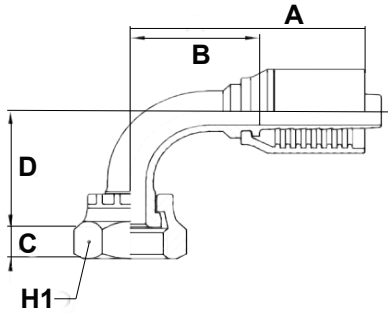

STYLE OF90T-SW

O-Ring Face Seal
Female Swivel
90° Bent Tube

Part No.	Thread Size	Hose ID (Inches)	Dimensions									
			A		B		C		D		H1	
			in	mm	in	mm	in	mm	in	mm	in	mm
4OF90T-4SW	9/16-18	1/4	2.14	53	1.13	28.0	.330	8.5	1.26	32.0	.688	32.0
6OF90T-6SW	11/16-16	3/8	2.22	56	1.25	32.0	.370	9.5	1.50	38.0	.810	20.6
8OF90T-8SW	13/16-16	1/2	3.48	63	1.38	35.0	.430	11.0	1.61	41.0	.938	23.8

Hydraulic Hose

A

Hydraulic Fittings

B

Support Products & Crimping Equipment

C

Technical Information & Guidelines

D